

# FT-610

Free cut

Ø 1.0 fiber optic core × 1

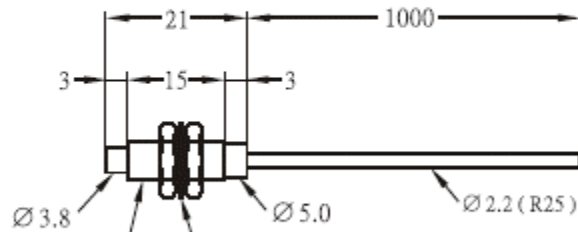

**RIKO**

www.riko.com

M6 P0.75 Nickel plated brass  
Washer toothed lock Ø 11;  
Nuts width across flats 10 mm, thickness 2.5 mm

# FT-610-I

Free cut

Ø 1.0 fiber optic core × 1

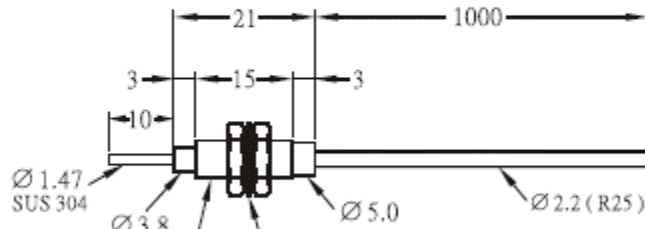

**RIKO**

www.riko.com

M6 P0.75 Nickel plated brass  
Washer toothed lock Ø 11;  
Nuts width across flats 10 mm, thickness 2.5 mm

# FT-610-L

Free cut

Ø 1.0 fiber optic core × 1

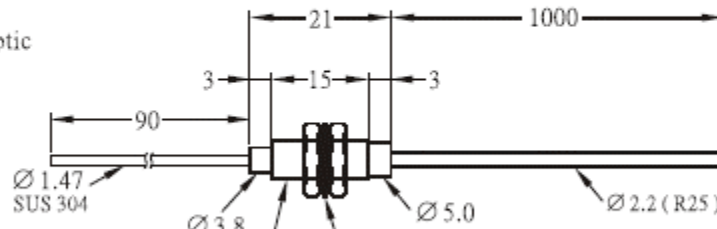

**RIKO**

www.riko.com

M6 P0.75 Nickel plated brass  
Washer toothed lock Ø 11;  
Nuts width across flats 10 mm, thickness 2.5 mm

# FTX-610

Free cut

Ø 1.5 fiber optic core × 1

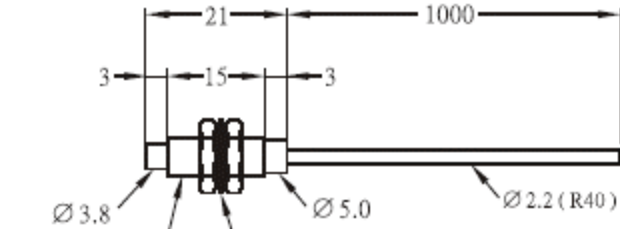

**RiKO**

www.riko.com

M6 P0.75 Nickel plated brass Washer toothed lock Ø 11; Nuts width across flats 10 mm, thickness 2.5 mm

# FTX-610-M

Free cut

Ø 1.5 fiber optic core × 1

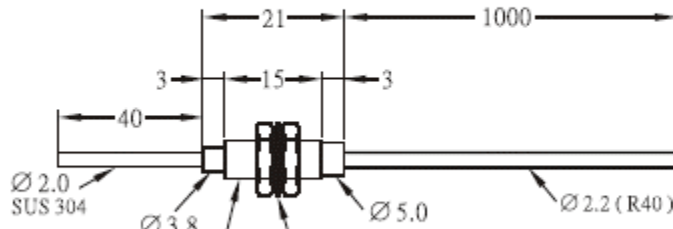

**RiKO**

www.riko.com

M6 P0.75 Nickel plated brass Washer toothed lock Ø 11; Nuts width across flats 10 mm, thickness 2.5 mm

# FTY-610

Minimum bend radius R2

Free cut

Ø 1.0 fiber optic core × 1

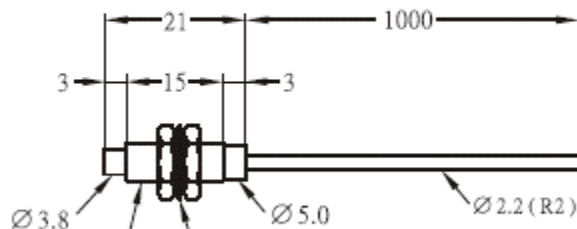

**RiKO**

www.riko.com

M6 P0.75 Nickel plated brass Washer toothed lock Ø 11; Nuts width across flats 10 mm, thickness 2.5 mm

# FTY-610-I

Minimum bend radius R2

Free cut

Ø 1.0 fiber optic core × 1

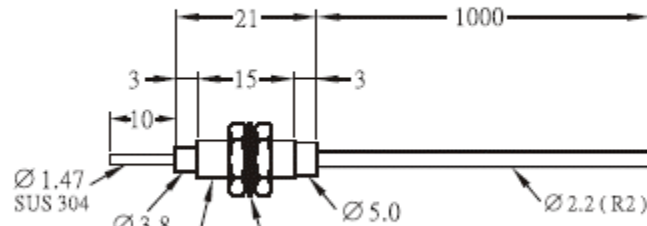

**RiKO**  
www.riko.com

M6 P0.75 Nickel plated brass  
Washer toothed lock Ø 11;  
Nuts width across flats 10 mm, thickness 2.5 mm

# FTY-610-S

Minimum bend radius R2

Free cut

Ø 1.0 fiber optic core × 1

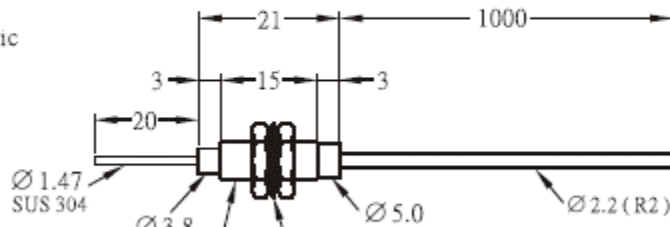

**RiKO**  
www.riko.com

M6 P0.75 Nickel plated brass  
Washer toothed lock Ø 11;  
Nuts width across flats 10 mm, thickness 2.5 mm

# FTY-610-M

Minimum bend radius R2

Free cut

Ø 1.0 fiber optic core × 1

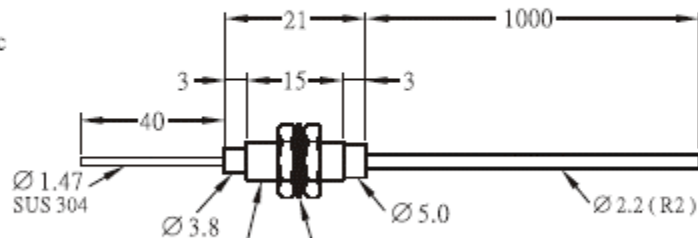

**RiKO**  
www.riko.com

M6 P0.75 Nickel plated brass  
Washer toothed lock Ø 11;  
Nuts width across flats 10 mm, thickness 2.5 mm

# FTY-610-L

Minimum bend radius R2

Free cut

Ø 1.0 fiber optic core × 1

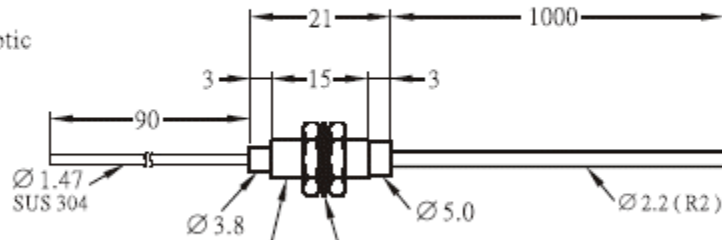

**RIKO**  
www.riko.com

M6 P0.75  
Nickel plated brass

Washer toothed lock Ø 11;  
Nuts width across flats 10 mm, thickness 2.5 mm