

Features:

- Space saving design, offering complete solutions for the needs of holding, clamping and short-stroke movement.
- Up to standard specifications, good interchangeability.
- Mounting directly to equipment, saving cost, more conveniently.



Bore \ Stroke	5	10	15	20	25	30	35	40	45	50
ø20	○	○	○	○	○	○	-	-	-	-
ø25	○	○	○	○	○	○	-	-	-	-
ø32	○	○	○	○	○	○	-	-	-	-
ø40	○	○	○	○	○	○	○	○	-	-
ø50	○	○	○	○	○	○	○	○	○	○
ø63	○	○	○	○	○	○	○	○	○	○
ø80	○	○	○	○	○	○	○	○	○	○

Specifications:

Action	Standard	Double rod end
Series	HD	HDW
Bore	ø20, ø25, ø32, ø40, ø50, ø63, ø80	
Operating fluid	Petroleum based oil	
Operating pressure	3-70kgf/cm ²	
Proof pressure	210kgf/cm ²	
Speed range	8-100 mm/sec	
Temperature range	-10°C~+70°C	

How to Order:

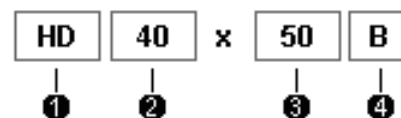

①	Series: HD:Standard HDW:Double piston rod type
②	Bore (mm)
③	Stroke (mm)
④	No code:Standard B:Piston rod male thread

External Dimensions:

- HD Standard type

- HDW Double piston rod type

- Male thread-B type

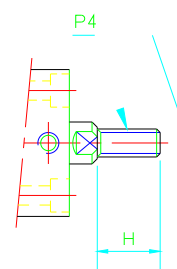
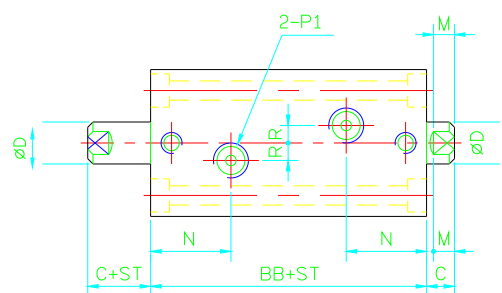
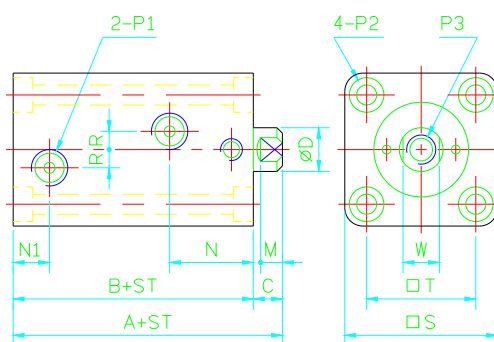

Bore	A	B	BB	C	D	H	M	N	N1	P1	P2	P3	P4	R	W	T	S
20	51	43	56	8	12	18	6	23	10	1/8	ø5.5 thru hole, c'bore ø9.5xdp5.5, both sides	M8x1.25	M10x1.25	5	10	30	42
25	53	45	58	8	14	20	6	23	10	1/8	ø5.5 thru hole, c'bore ø9.5xdp5.5, both sides	M10x1.5	M12x1.25	5	12	36	48
32	64	54	69	10	20	25	7	28	12	1/4	ø6.6 thru hole, c'bore ø11xdp6.6, both sides	M12x1.75	M16x1.5	10	17	47	62
40	65	55	70	10	25	30	7	28	12	1/4	ø9 thru hole, c'bore ø14xdp9, both sides	M16x2.0	M22x1.5	10	22	52	70
50	71	60	76	11	30	35	8	30	13	1/4	ø11 thru hole, c'bore ø17.5xdp11, both sides	M20x2.5	M26x1.5	10	27	58	80
63	80	67	85	13	35	40	10	32	14	3/8	ø14 thru hole, c'bore ø20xdp14, both sides	M24x3.0	M30x1.5	10	32	69	94
80	95	78	95	17	40	45	14	35	18	3/8	ø16 thru hole, c'bore ø23xdp16, both sides	M27x3.0	M36x1.5	15	36	86	114