

# AKS Series CLAMP CYLINDERS

Bore Ø40, Ø50, Ø63, Ø80

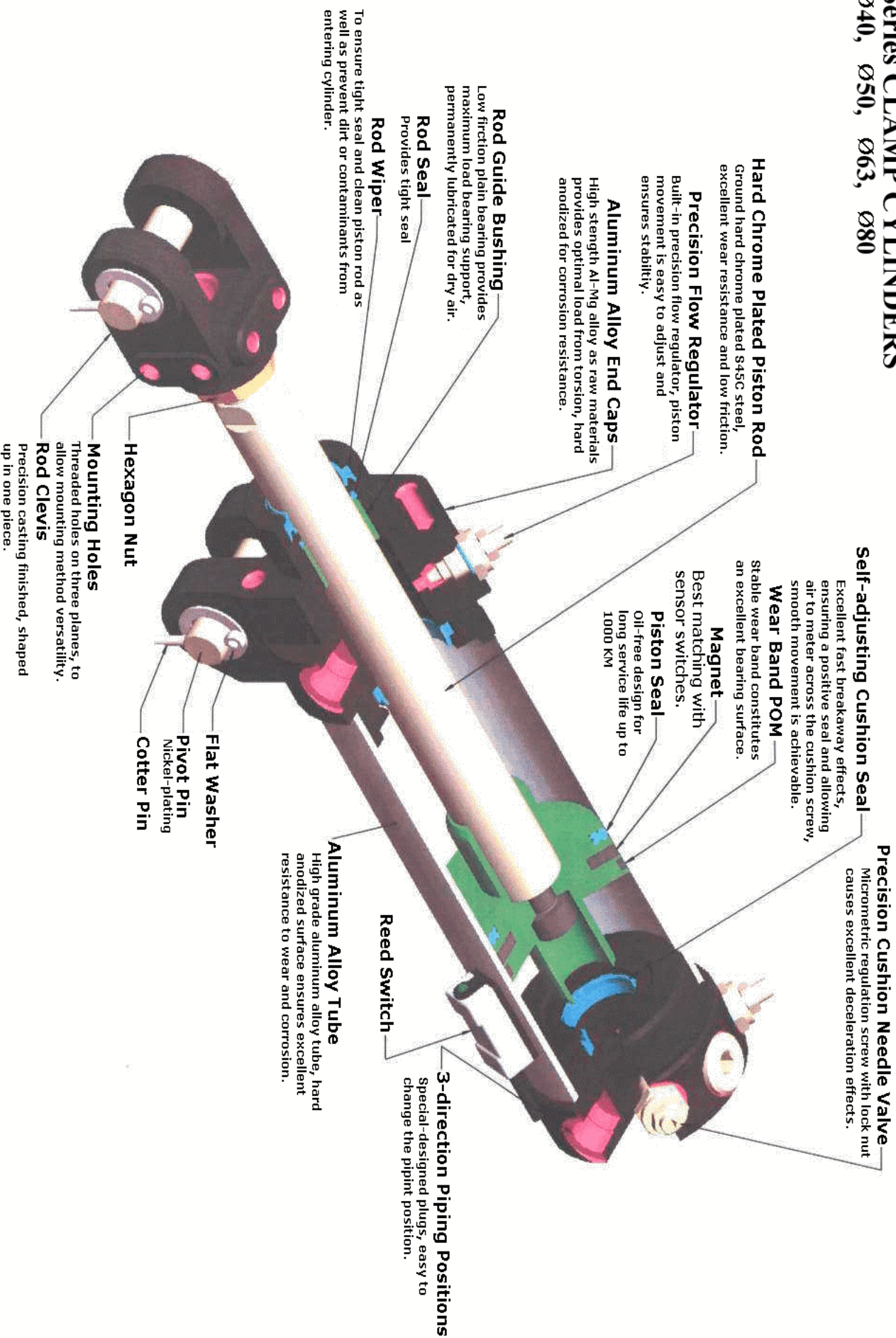

## Features:





- Using anodized aluminium alloy barrel ensures better abrasion and corrosion proof.
- Use unlubricated bush, seals for durable service life.
- Piping position is versatile.
- With cushion at both ends to reduce impact.
- Available with magnetic piston for reed switch.



## Specifications:

<b>Action</b>	Standard type	Acting type
<b>Series</b>	AKS	AKSR
<b>Bore</b>	ø40, ø50, ø63, ø80	
<b>Operating fluid</b>	Compressed Air	
<b>Operating pressure</b>	0.7-9.9 kgf/cm <sup>2</sup>	
<b>Proof pressure</b>	15 kgf/cm <sup>2</sup>	
<b>Speed range</b>	50-500mm/sec	
<b>Temperature range</b>	-10°C+70°C	
<b>Cushion</b>	With adj. cushion at both ends	
<b>Lubrication</b>	Not required	

## How to Order:

<b>AKS</b>	<b>R</b>	<b>40</b>	<b>*</b>	<b>50</b>	<b>Y</b>	<b>CS</b>	<b>2</b>
<b>Series</b>	<b>With magnet</b>	<b>Bore</b>		<b>Stroke</b>	<b>Mounting type</b>	<b>Reed switch</b>	<b>Switch quantity</b>
AKS Standard type 		ø40 ø50 ø63 ø80		25~150mm	Y Rod clevis  I Rod clevis 	CS-22: DC/AC 4~220V 	1 : 1 PC 2 : 2 PCS

## Weight Table:

type \ stroke	25	50	75	100	125	150	Above 150
<b>AKS 40</b>	909	1015	1122	1228	1335	1441	Per 25mm stroke add 107g
<b>AKS 50</b>	1026	1163	1300	1437	1574	1711	Per 25mm stroke add 137g
<b>AKS 63</b>	1300	1416	1533	1649	1766	1883	Per 25mm stroke add 117g

Unit: g

## Application Examples:

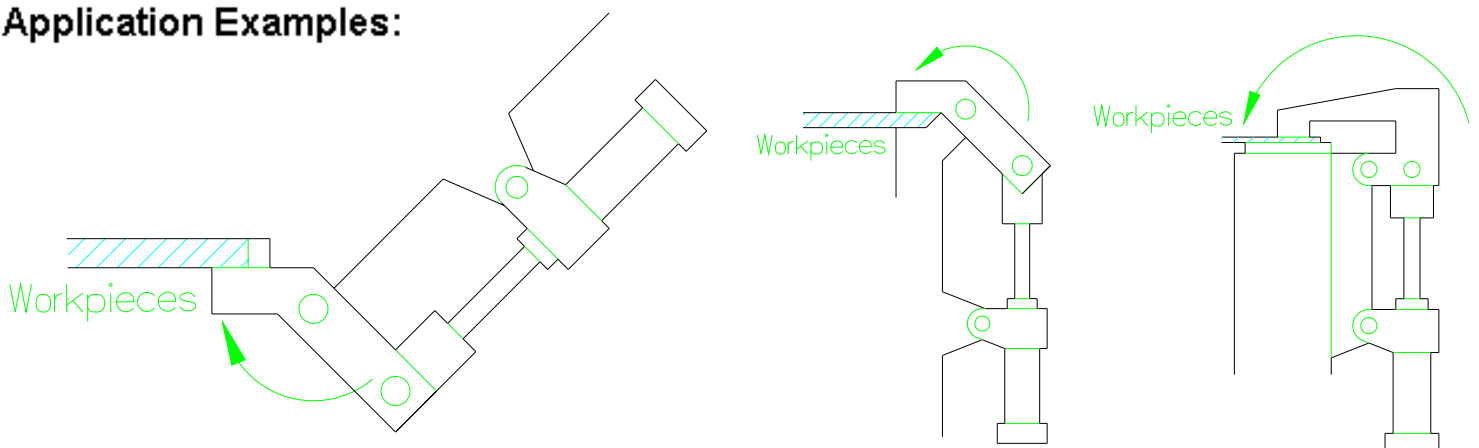

# External Dimensions:

- AKS 40, 50, 63

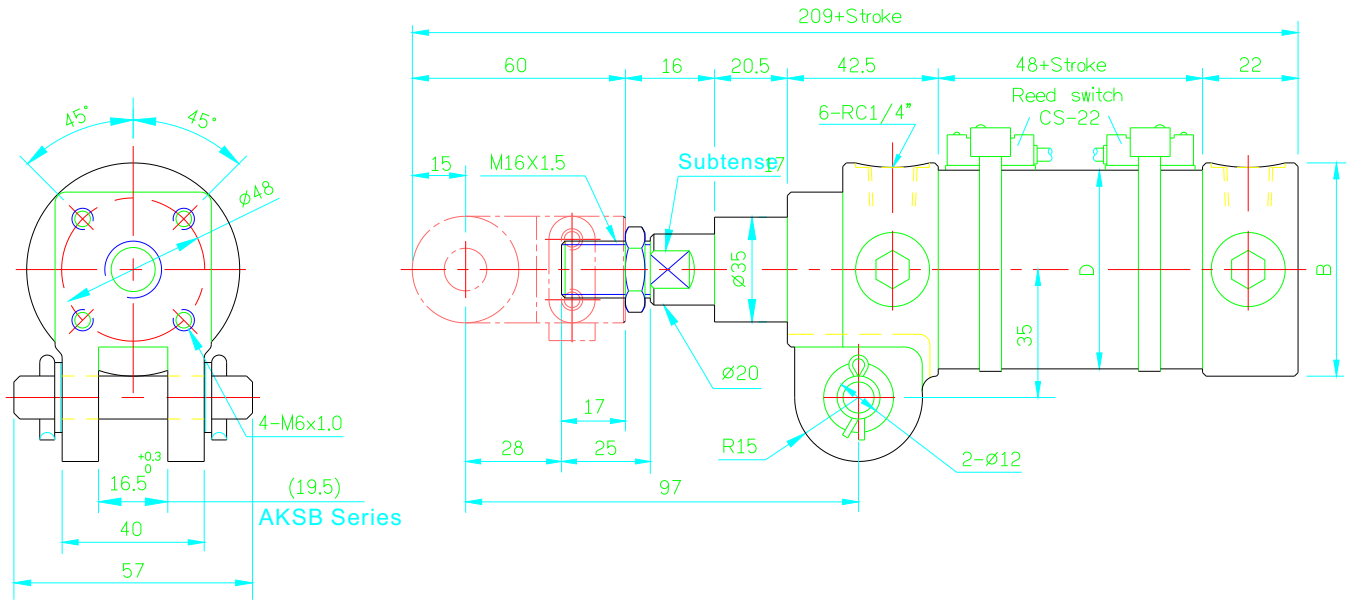

Bore	$\phi 40$	$\phi 50$	$\phi 63$
<b>B</b>	$\phi 49$	$\phi 59$	$\phi 69$
<b>D</b>	$\phi 45$	$\phi 55$	$\phi 68$

- Rod Clevis I:

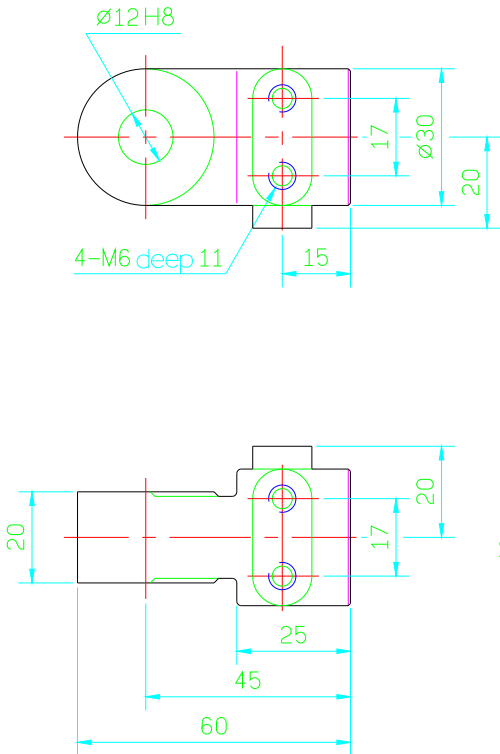

- Rod Clevis Y:

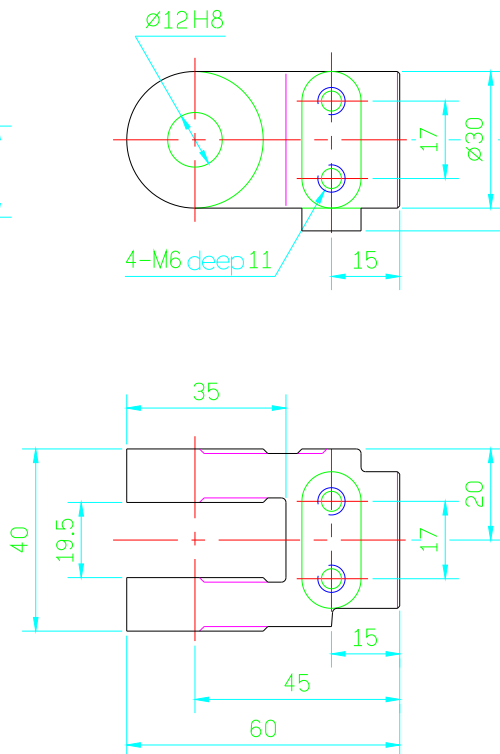

- Pin:

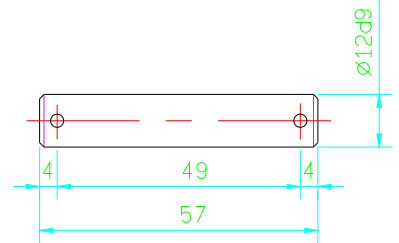

# External Dimensions:

- AKS 80

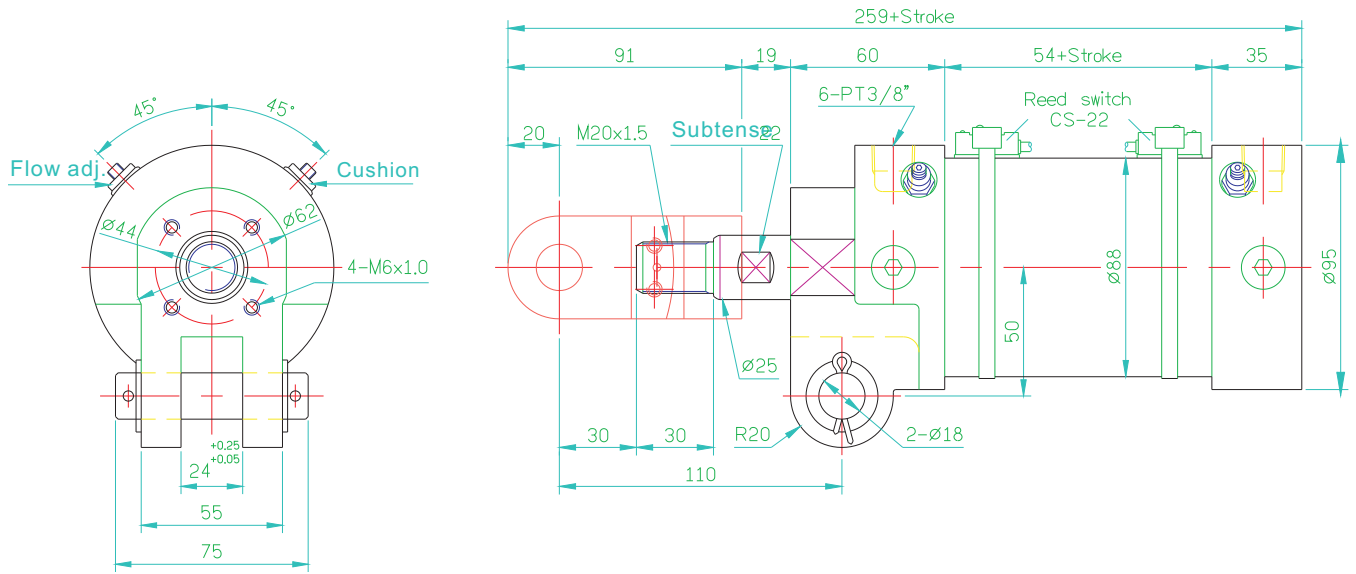

- Rod Clevis Y:

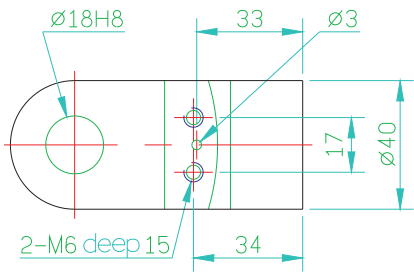

- Pin:

