

Features:





- Precision rolled endcaps, leak-proof construction.
- Low breakaway friction, high speed actuation.
- Magnetic piston for reed switch sensing optional.
- Strong non-corrosion barrel.
- End of stroke cushioned by polyurethane rings.



Specification:

Action	Double acting with magnetic piston
Bore	ø20, ø25, ø32, ø40
Operating fluid	Compressed air
Operating pressure	0.7Mpa(7kgf/cm ²)
Proof pressure	1.05Mpa(10kgf/cm ²)
Piston speed range	50~700 mm/sec
Temperature range	-10 ^o C~+70 ^o C
Cushion	Bumper
Lubrication	Not required or use ISO VG32

How to Order:

AC	16 x	100	LB	MT	2
Series	Bore	Stroke	Mounting type	Reed switch	Switch quantity
AC Standard type 	ø20 ø25 ø32 ø40	25~300mm	LB Bracket  FA/FB Flange  SDB Rear hinge 	MT-22: DC/AC 4~220V 	1 : 1 PC 2 : 2 PCS

Standard Stroke:

Type \ Stroke	25	50	75	100	125	150	200	250	300	350	400	450	500
ø20													
ø25													
ø32													
ø40													

*Note: " "stands for Stand Strokes in stock; " " stands for optional strokes on request.

Internal Construction:

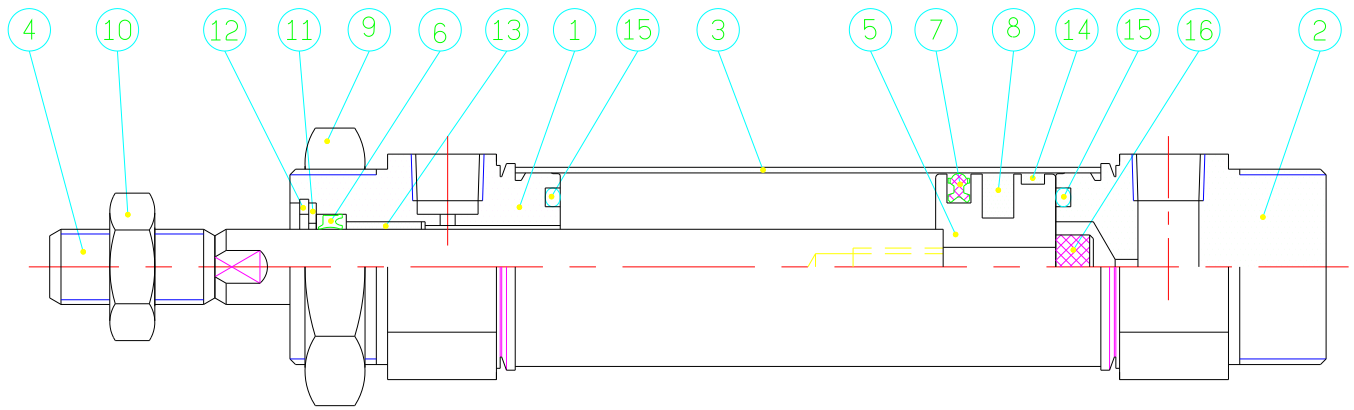

Part lists:

NO	Description	Material	Qty
1	Front end cover	Anodized aluminium alloy	1
2	Rear end cover	Anodized aluminium alloy	1
3	Barrel	Stainless steel	1
4	Piston rod	Hard chrome plated carbon steel	1
5	Piston	Aluminium alloy	2
6	Rod seal	NBR	1
7	Piston seal	NBR	2
8	Magnet	Rubber magnet	1
9	Mounting nut	SS41	1
10	Hex screw	SS41	1
11	Washer	Stainless steel	1
12	Snap ring	SK5M	1

NO	Description	Material	Qty
13	Bush	Oil filled plastic	1
14	Wear ring	POM	1
15	Bumper	NBR	2
16	Hex socket head screw	Carbon steel	1

Seals List:

Bore \ Stroke	6 Rod seal	7 Piston seal	15 Wear ring
ø20	DRP 8	APA 20	WR 20
ø25	DRP 10	APA 25	WR 25
ø32	DRP 12	APA 32	WR 32
ø40	DRP 16	APA 40	WR 40

Cylinder Weight Table:

Bore \ Stroke	25	50	75	100	125	150	200	250	300	Max. stroke (mm)	Above 300mm
ø20	175	191	207	223	239	255	287	319	351	400	Per 50mm stroke add 32g
ø25	235	267	298	329	360	391	453	515	577	450	Per 50mm stroke add 62g
ø32	376	416	456	496	536	576	656	736	816	450	Per 50mm stroke add 80g
ø40	636	699	762	825	888	951	1077	1203	1329	500	Per 50mm stroke add 126g

External Dimensions:

• Standard type

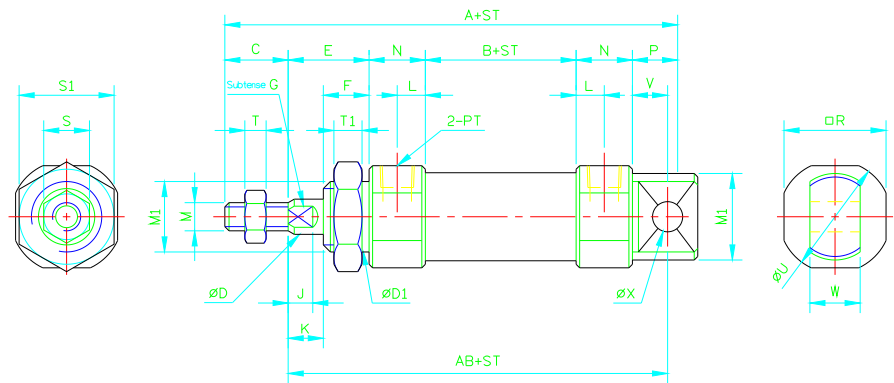

Bore	A	AB	B	C	øD1	øD	E	F	J	K	L	M1	M	N	P	R	S1	S	T1	T	øU	V	W	X	PT (Rc)
20	125	96	30	20	20	8	22	13	5	9	8	M20x1.5	M8x1.25	16	21	24	26	13	8	5	28	12	12	8	1/8"
25	128	97	28	22	26	10	23	13	6	10	9	M26x1.5	M10x1.25	17	21	30	32	17	8	6	33.5	12	12	8	1/8"
32	136	102	32	22	26	12	23	13	6	10	9	M26x1.5	M10x1.25	16	27	34.5	32	17	8	6	37.5	15	20	10	1/8"
40	165	129	40	24	32	16	26	16	6	10	13	M32x1.5	M14x1.5	24	27	42.5	41	22	10	8	46.5	15	20	10	1/4"

• Short type

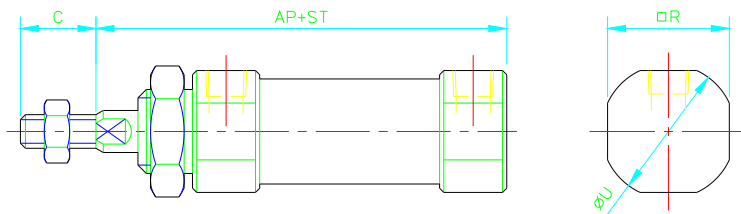

Bore	AP	C	R	øU
20	84	20	24	28
25	85	22	30	33.5
32	87	22	34.5	37.5
40	114	24	42.5	46.5

• Flange mounting (FA/FB)

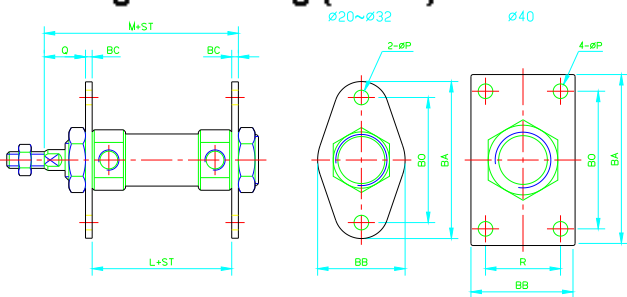

Bore	BA	BB	BC	M	L	BO	P	Q	R
20	75	42	3.2	87.2	62	60	7	18.8	-
25	75	40	3.2	88.2	62	60	7	19.8	-
32	75	40	3.2	90.2	64	60	7	19.8	-
40	82	50	5.5	119.5	88	60	7	20.5	36

• Bracket (LB)

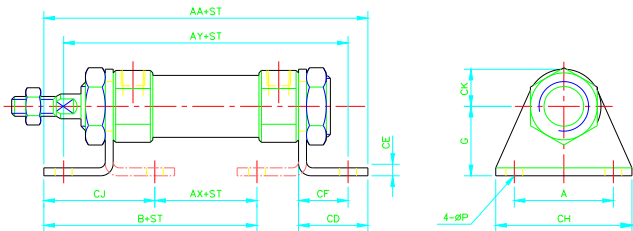

Bore	AA	AX	AY	B	CJ	CD	CF	CE	CH	CK	A	G	øP
20	118	28.4	102	73.2	44.8	28	20	3.2	55	15	40	25	6.8
25	118	28.4	102	73.2	44.8	28	20	3.2	55	19	40	28	6.8
32	120	30.4	104	75.2	44.8	28	20	3.2	55	19	40	28	6.8
40	162	48.4	134	101.2	52.8	33	23	3.2	75	25	55	30	7

• Rear hinge mounting (SDB)

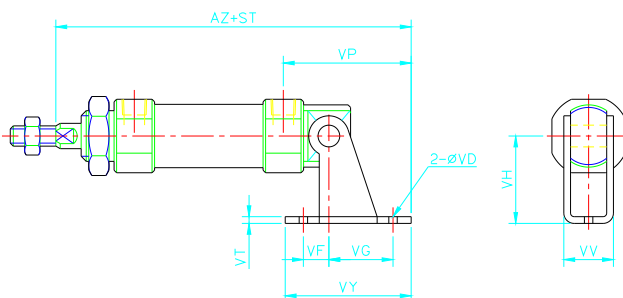

Bore	AZ	VD	VF	VG	VH	VP	VT	VV	VY
20	133	6.8	15	30	30	37	3.2	18.4	59
25	134	6.8	15	30	30	37	3.2	18.4	59
32	152	9	15	40	40	50	4	28	75
40	179	9	15	40	40	50	4	28	75